

AirTrack Factory



USER MANUAL

Enjoy your AirProduct!

Thank you for purchasing one of our safe and fun products!

This manual describes how to use AirTrack Factory's products.

Please make sure to read through the safety instructions carefully before using your AirProduct. Should anything be unclear, do not hesitate to contact us! We hope you enjoy your new equipment.

Train safe, have fun and level up!

AirTrack Factory



Content

Chapter	Page
Play it safe	6
Safety Instruction	7
Setting up	8
Step by step set-up	9
Packing	10
Step by step packing	11
Problem solving	12
Contact	14
FAQ	15





SAFETY INSTRUCTIONS

These instructions apply to all inflatable products from AirTrack Factory that can be used at home as well as in a gym. These products will be referred to as 'AirProducts' or the 'equipment'.

Important: This product is not a toy. It is professional training equipment for gymnastics, cheerleading, tumbling, school sports, showgroups, martial arts, parkour, freerunning and tricking.

USE AIRPRODUCTS ONLY FOR THEIR INTENDED PURPOSE

Personal

- This equipment is not suitable for children under 5 years.
- Do not allow more than one person at a time to use the AirProduct.
- Do not wear shoes while on an AirProduct for they may damage the surface.
- Do not jump or land closer than 20 cm to a valve.
- Consult an instructor prior to use.
- Use equipment only under the supervision of trained and qualified instructors.
- Use equipment with trained spotters and the proper spotting equipment.
- Follow a progressive learning pattern. Assure basic skills are achieved before attempting more advanced skills.

Outdoor

- When setting up the AirProduct outdoors, use a groundsheet to avoid damaging the AirProduct.
- Do not expose AirProducts to heat, including heat from exposure to the sun.
- Never leave an AirProduct outside unattended and keep the air pressure under the maximum values found in this guide.
- Do not use the AirProduct in the rain or snow. While inflating the equipment, electrocution may occur and also the surface will be slippery which can cause injuries.
- The AirProduct is not a flotation device.

Maintenance

- Never pack, store or transport the AirProduct when it is moist or dirty.
- The AirProduct can be cleaned with water and soft soap. Do not use industrial cleaning products.
- Do not use the AirProduct when it's damaged, leaking or when parts are worn or missing.

Warnings

- Be aware that AirProducts are not designed as landing mats.
- AirProducts may move during use which could result in serious injury.
- Serious injury (including permanent paralysis or death) could result from any activity involving motion, rotation or height.
- All users of this equipment assume this risk of serious injury.
- Mats cannot and do not eliminate hazards.

Positioning and set-up

- Do not bring any sharp items on or close to the AirProduct.
- Never place an AirProduct near overhead obstructions, such as low ceilings, trees or power lines, nor place the equipment on a slope greater than 5%.
- The area on which the AirProduct is placed must be clean, dry, flat and free of obstacles and walls.
- Always set up the AirProduct in the same area where you will be using it. Do not drag or throw it. Lift it by the handles and avoid scraping.
- Do not use the AirProduct in humid areas, electrocution may occur.

Pressure

- Do not use a compressor. Use only inflation equipment supplied by AirTrack Factory.
- Check the air pressure of the AirProduct before each training session.
- Assure that the AirProduct has sufficient air pressure to avoid bottoming out. Recommended air pressure levels can be found in this user manual.
- Use equipment only when all hard exposed surfaces are protected with proper mats.

PLAY IT SAFE

The thickness of an AirProduct has an effect on how the product can be used. Most of our products for home use are 10 cm thick. This goes for the AirFloors, AirBeams, and AirBoards. When products are 10 cm thick the pressure in the product needs to be high to prevent you from hitting the floor. Our recommended pressure levels for each body weight can be found in the table below, but in the end it's up to the users' preferences.

Body weight	10 cm thick	20 cm thick (P2)	30 cm thick (P3)
20 - 30 kg	70 - 80 mbar	40 - 50 mbar	30 - 40 mbar
30 - 60 kg	70 - 100 mbar	40 - 60 mbar	40 - 60 mbar
60 - 90 kg	100 - 140 mbar	60 - 70 mbar	60 - 70 mbar
90+ kg	150 mbar	75 mbar	75 mbar

The bounciness of the AirProduct depends on how much pressure you put in it. If filled up to the maximum pressure, an AirTrack can feel exactly like a dead floor (which is useful for competition training). Inflating it to a standard level will make it optimal for low to mid level training, while inflating it to a minimum level will make it more fun for recreational purposes.

Note: It is impossible to over-pressurize an AirProduct with the blowers we supply. To prevent damaging the AirProduct, never use a blower other than the one supplied with your equipment.



STEP BY STEP SET-UP

- !** Please make sure you have read the safety rules before proceeding to set-up your AirProduct.
1. Prepare a clean, flat surface for the AirProduct, take it out of the bag and make sure it's unrolled far enough to reach the valves.
 2. **OV10 blower / Foot pump**
Make sure the adapter is placed on the hose properly and the blower or footpump is set to blow.
Hitachi blower
Attach the cylindrical adapter to connect to a black valve, or the cone-shaped adapter for a grey valve.
- Using the grey valves?** Make sure the pin inside the valve is pressed *out*.
3. Start inflating the AirProduct until it reaches its final shape. Check if the pressure is okay by carefully testing the mat with your hands or a manometer (pressure gauge).
 4. Turn off and disconnect the blower.
 5. **Using the black valves?** Be careful not to damage the screw thread by forcing the cap on. Block the airflow with your hand before closing the valve.

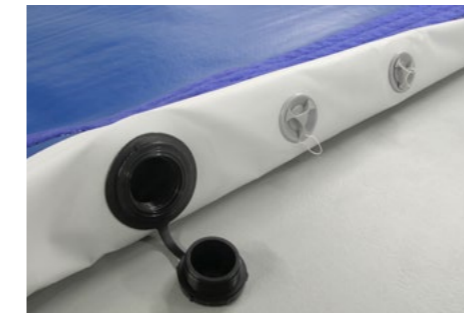

SETTING UP

Exciting! You're about to get started with your AirProduct.

Don't worry, setting up the AirProduct is quite simple. You don't want your brand new AirProduct to knock something over or scrape a wall, so be sure to find a clear spot, free of (sharp) objects. If you're setting up the AirProduct outdoors, make sure to place a ground cover underneath the equipment.

Do not use a compressor to inflate your AirProduct. Use only inflation equipment supplied by AirTrack Factory (shown below).



Hitachi blower



OV10 blower



Foot pump

	Hitachi blower	OV10 blower	Foot pump
Pressure	Low (0 - 90 mbar)	High (0 - 250 mbar)	High (0 - 300 mbar)
Speed	Fast inflation	Medium inflation	Slow inflation
Object size	Medium & large objects	Small & medium objects	Small objects
Valves	Black & grey valves	Grey valves	Grey valves

Using the grey valves? The pin inside the valve should still be out and no air should be leaking.



6. Use the Hitachi's cone-shaped adapter or an OV10 blower on the grey valves to fine-tune the pressure. A manometer helps determine the perfect pressure.
7. Before each training, check the pressure with the manometer or by jumping on the AirProduct to test if the pressure is up to your standards. *If you bottom out and feel the floor underneath, the AirProduct is not ready for use.*
8. Enjoy your training!



PACKING

So, how did you like it? We hope you enjoyed your training!

Time to pack up the AirProduct and store it. Before packing up, make sure the mat is dry and clean.

There are a few things to know about rolling up an AirProduct:

1. You can speed up the deflation by sucking out the remaining air with the blower. Simply attach the blower's tube to the suction side of the blower and connect it to the AirProduct.
2. The AirProduct has to fit the bag, so keep the bag close while determining the width of the folds. Save some extra space on the sides for the roll might turn out wider than planned.
3. When folded, the black valves should not end up on top of each other. The valves may damage themselves when they apply pressure on each other.

STEP BY STEP PACKING

1. Open all valves to start the deflation. Start folding or rolling up the AirProduct to speed up the deflation. The blower can be used to deflate the object more rapidly. Simply attach the blower's tube to the deflation side of the blower (see pictures below).



2. When most of the air is out, fold the AirProduct so the width matches the transport bag. The black valves should not end up on top of each other.



3. Roll up the AirProduct towards the valves so they remain unblocked for as long as possible. The tighter you roll up the object, the easier it will be to transport it.



4. **IMPORTANT:** After rolling up the AirProduct make sure to close all valves! This prevents the caps from damaging the valves' screw thread. Use the black strap to keep the mat rolled up tight.
5. Slide the bag over the rolled up AirProduct, then roll over the bag so the opening is facing upwards. Close the Velcro flaps, then the other flaps and close the bag by tightening the straps.



Help! My AirProduct is leaking!

Make sure all valves are closed properly.

Grey valves: The pin inside the grey valve are often left open (pin in) when the cap is closed, which means the valve will still be leaking air. Always make sure the grey valve is closed (pin out) before closing the valve.

Black valves: Black valves are equipped with a rubber ring-shaped inlay that prevents air from escaping, and slightly pop out of the cap. Closing the valve in this condition may cause the rubber inlay to take permanent damage. Please contact us if you require a rubber ring replacement.

Before closing the black valves, check if the rubber inlay is still in its correct position. The pictures below show the rubber inlay in its correct (left) and incorrect (right) position.

Still leaking? Contact your distributor or AirTrack Factory and we'll help you out.

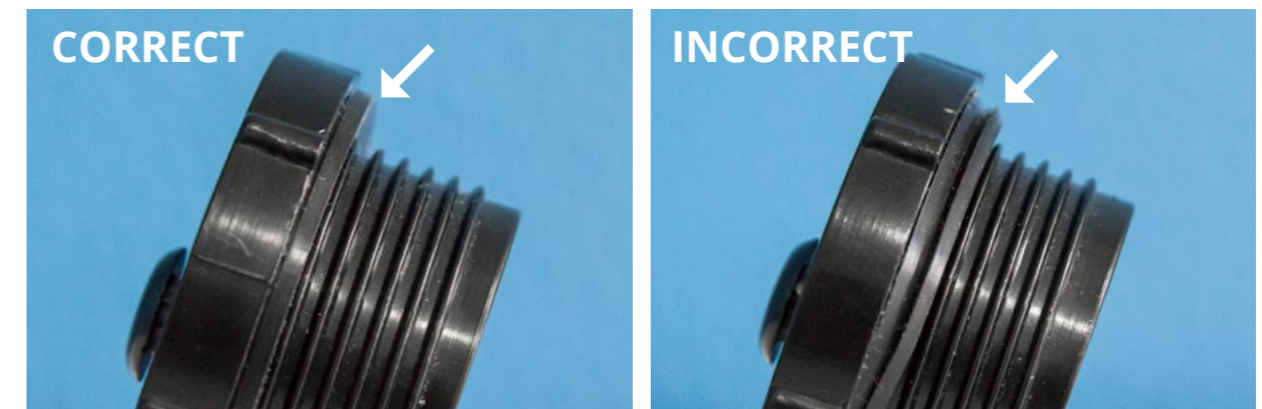

PROBLEM SOLVING

Can't fit the AirProduct back in the bag?

When rolling up the AirBeam, make sure that the center line is facing down!

We recommend using the blower to get the last bits of air out of the AirProduct. Our blowers have an input and an output vent. One for inflating and one for deflating. For deflating, connect the blowers' adapter to the input side (Hitachi: on the side, OV10: on the back) of the blower and deflate until the AirProduct is flat.



When I detach the blower from the AirProduct's grey valve, all the air goes out.

Make sure the pin inside the valve is closed (pin out, see photo below) before attaching the blower. The pin should remain closed (pin out) during inflation and usage. Only open the valve (pin in) when adjusting pressure or deflating.

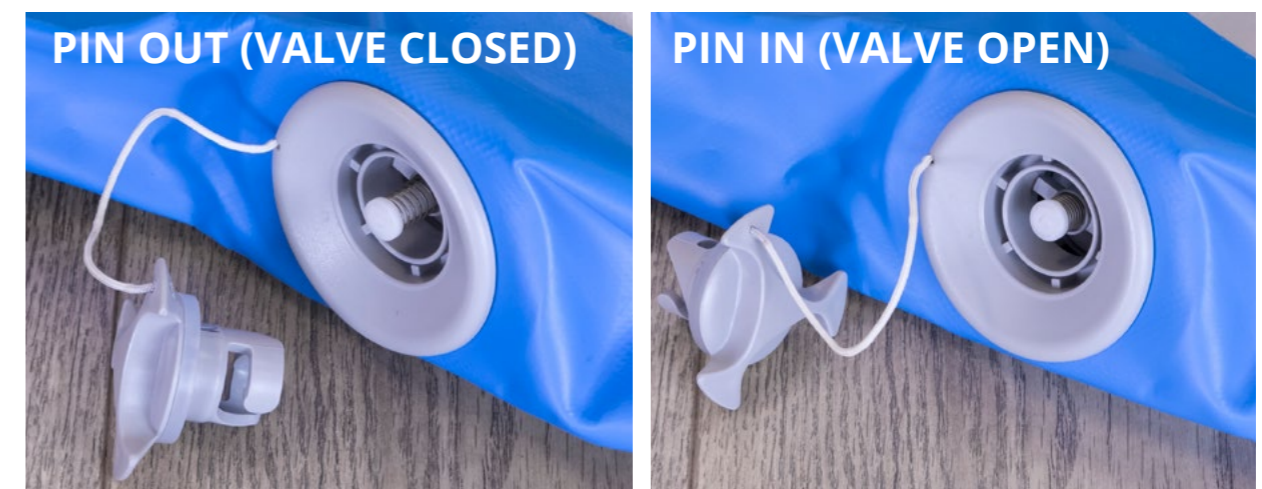



CONTACT

Should you have any remaining questions or comments regarding this user manual, please do not hesitate to contact us.

AirTrack Factory

Bijsterhuizen 11-78
6546AS Nijmegen
The Netherlands

T. +31 (0)24 8909659
E. info@airtrackfactory.com
W. www.airtrackfactory.com



F.A.Q.

How long does it take to inflate an AirProduct?

Large objects: The majority of the AirProducts can be inflated within 4 minutes thanks to our high performance blowers. A 12 x 2 m AirTrack P2 takes 2½ min. to inflate using a single Hitachi blower.

Small / home use objects: Using the foot pump, AirProducts can be inflated within minutes. However, you won't beat the high speed inflation of our OV10 blowers!

Is there a chance of damaging an AirProduct by over pressurizing it?

No, the extreme pressure needed to actually damaging an AirProduct can not be reached with the blowers we supply. Do not use any blowers or compressors not supplied by AirTrack Factory or one of its distributors to inflate the AirProduct.

24 Hours after inflation the airtrack is soft.

AirTracks are not designed to maintain their pressure overnight. Differences in temperatures and weather influence the pressure inside the AirProduct. Make sure to set the pressure to your preferences before each training. If you have any doubts, feel free to contact us for a professional opinion.

What is the lifespan of your products?

Obviously this will depend on how the products are used and in what frequency. A lifespan of more than 7 years is definitely not uncommon.

What guarantees do you give on your products?

We give 2 years guarantee on our products. The Consumer is responsible for delivery to, and pickup from, the closest authorised dealer. Please check our terms of delivery for more detailed info.

When our AirProduct is leaking, how can you help us?

First of all, check if all valves are properly closed. If a valve is leaking, please contact us. A puncture in the surface or damage to a seam could cause your AirProduct to leak. For both options we have a solution that is both simple and cheap. You do not have to send the equipment back to us; we will send the repair material to you or assist you in purchasing it locally. Repairs take no longer than 10 minutes.

What is the difference between these AirTracks and the old Tumble Tracks?

The new generation AirTracks from the AirTrack Factory are very airtight and the pressure can be regulated. Therefore you do not need a big, expensive blower that makes a lot of noise and disturbs your training. A small handblower is enough to inflate even the biggest AirTracks within 4 minutes. Also, the AirTrack resembles the real gymnastic floor much better because it's flatter.



AirTrack Factory

Klubben.no
Færdervegen 49
2270 Flisa
Norway

www.klubben.no
info@klubben.no
facebook.com/klubben.no
instagram.com/klubbenno